

Theta III

Lighted Mirror Technical Specifications

Features & Benefits

Trusted	<ul style="list-style-type: none"> Made in the USA or CHINA
Model Room	<ul style="list-style-type: none"> 4-6 week lead time
Manufacturing	<ul style="list-style-type: none"> Shipping flexibility and dependable lead times 2-part enclosure design for easy installation
Entirely Customizable	<ul style="list-style-type: none"> Infinite dimensions and sizes for every project Optional add-ons and customizations
Hospitality Grade Products & Production	<ul style="list-style-type: none"> Copper-free coatings to prevent black-edge corrosion Powder-coated metal chassis provides easy access to electrical components
Sustainable Lighting	<ul style="list-style-type: none"> High efficiency lighting saves energy and reduces electrical costs Mercury-free LED lighting reduces environmental impact
Safety Compliant	<ul style="list-style-type: none"> ETL Certified Hard-wired or plug-in connection

Lighted Mirror Specifications

MunnWorks Signature LEDs	<ul style="list-style-type: none"> UL Listed, CE Certified 90+ CRI (Color Rendering Index) 800+ Lumens/Foot Standard 3000K Lighting Temperature Compatible 0-10V Dimming Control 50,000 Hour LED Life
Dimensions	<ul style="list-style-type: none"> Glass Thickness: 3/16" Copper-Free Coating Mirror Standard Overall Depth: 1-3/4"
Optional Add-Ons	<ul style="list-style-type: none"> Touch On/Off Dimmable Defogger Digital Clock Custom Etching Design Vanishing Television Alternate Color Temps LED Night Lights All mirrors are customizable and can be combined with our renowned frame line

Standard Dimensions

• 30"W x 36"H	• 30"W x 42"H	• 30"W x 48"H
• 36"W x 36"H	• 36"W x 42"H	• 36"W x 48"H
• 42"W x 36"H	• 42"W x 42"H	• 42"W x 48"H
• 48"W x 36"H	• 48"W x 42"H	• 48"W x 48"H
• 54"W x 36"H	• 54"W x 42"H	• 54"W x 48"H

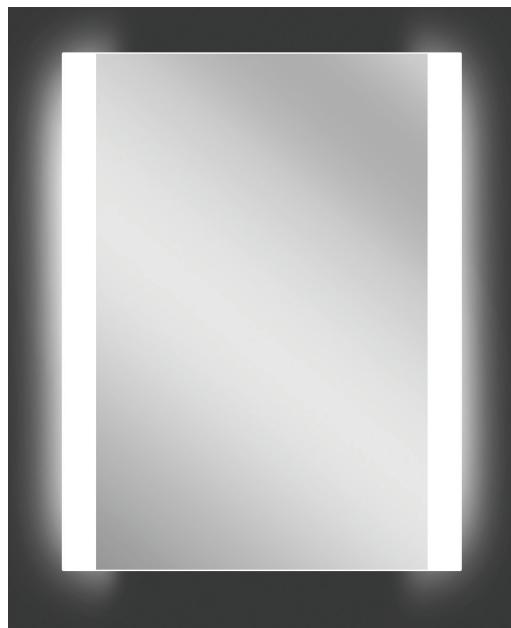

PRODUCT IMAGE



DETAIL IMAGE

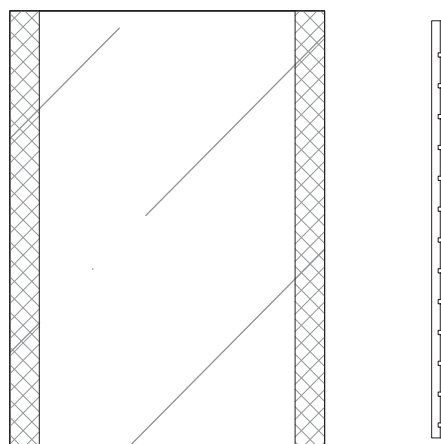

SHOP DRAWING